

EVERYTHING SHOWN IS NOT EXACT.
THIS DRAWING SHOULD ONLY BE USED TO SHOW WHAT
EACH OPTION MIGHT LOOK LIKE.

NO EASEMENT GIVEN BACK TO CITY.
NO PARKING ON SOUTH SIDE
(NO FLAGS)

- CHANGES TO PROPERTY
- CHURCH DOESN'T GIVE BACK ANY EASEMENT. WE WILL HAVE NO PARKING ON SOUTH SIDE.
 - RAMP/STAIRS ADDED TO NORTH SIDE PARKING. REMOVE OLD STEPS.
 - NORTH PARKING WILL MOVE SOUTH AND GREEN SPACE WILL BE WIDENED. EXISTING TREES WILL BE REMOVED.
- NOT SURE
- IMPORTANT:
- THE CITY IS NOT BUYING THE EASEMENT BACK. THEY GAVE IT TO US LONG AGO.
 - THE CHURCH WILL NOT HAVE TO PAY FOR ANYTHING THE CITY DECIDES TO DO. (ALL THE CONSTRUCTION IS AT THE EXPENSE OF THE CITY)
 - CHURCH SIGN WILL NOT BE REPLACED. THE SIGN WILL BE WITHIN 1' TO 2' OF SIDEWALK.
 - GRACE WILL PICK AN OPTION AT JULY'S VOTERS MEETING.
 - NO MATTER WHAT OPTION GRACE PICKS, THE CITY STILL HAS THE ULTIMATE DECISION.
 - IF YOU HAVE ANY QUESTIONS PLEASE ASK THEM (SEE TRUSTEE'S JEREMY CAGLE OR MATT PROCTOR)

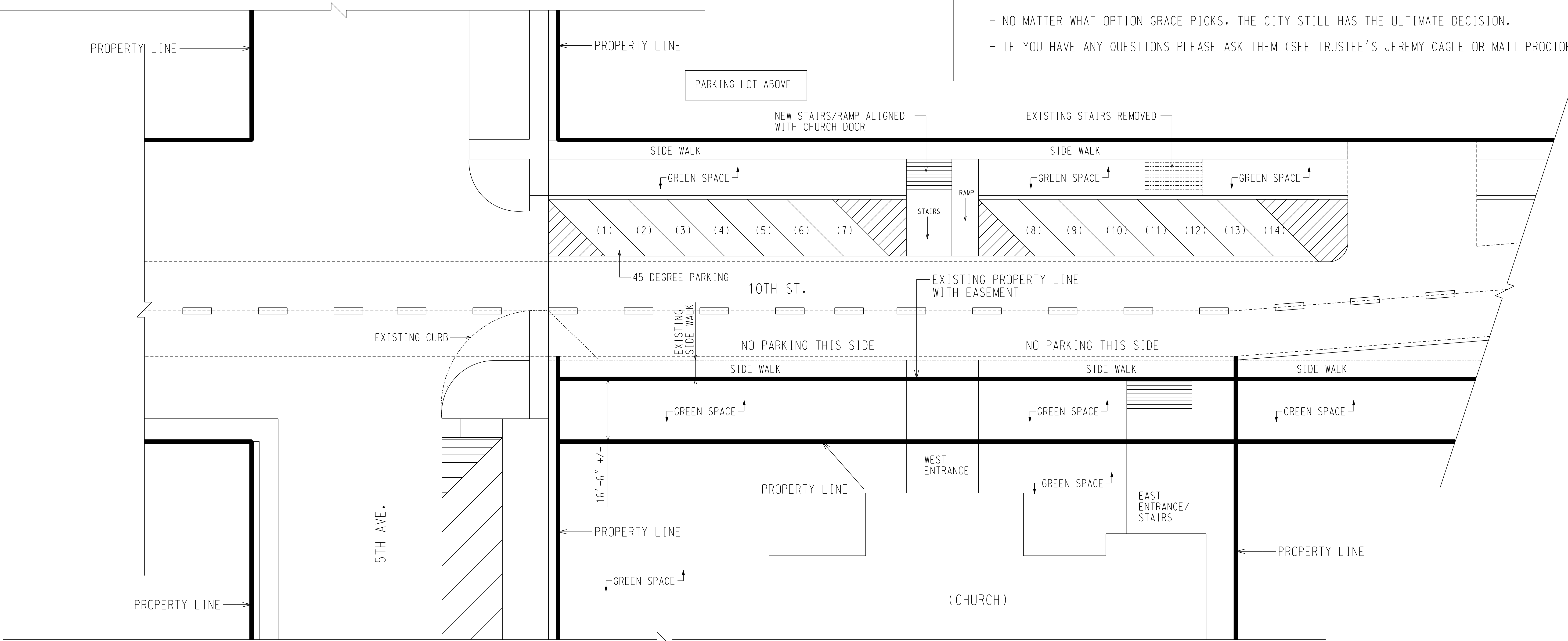

OPTION #4 SHOWN
DO NOTHING AND HAVE NO PARKING ON SOUTH SIDE

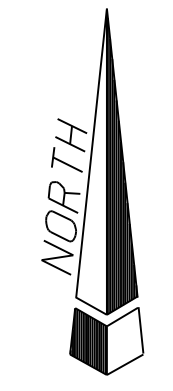

EVERYTHING SHOWN IS NOT EXACT.
THIS DRAWING SHOULD ONLY BE USED TO SHOW WHAT
EACH OPTION MIGHT LOOK LIKE.

(PINK FLAGS)

(SEE PINK FLAGS FOR LOCATION OF INSIDE FACE OF CURBS)

NOTE: THE FLAGS ONLY SHOW WHERE THE FRONT TIRE WILL BE.
6'-0" +/- FOR SIDE WALK & CURB MUST BE ADDED BEYOND THE
LOCATION OF FLAGS. THIS WILL BE WHAT THE CHURCH GIVES
BACK TO THE CITY.

CHANGES TO PROPERTY

- CHURCH GIVES BACK 16'-6" +/- OF EASEMENT FOR 45 DEGREE PARKING.
- EAST ENTY STAIR LANDING (AT TOP) WILL BE SHORTENED. STAIRS WILL BE REPLACED AND STILL FACE NORTH.
- RAMP/STAIRS ADDED TO NORTH SIDE PARKING. REMOVE OLD STEPS.
- NORTH PARKING WILL MOVE SOUTH AND GREEN SPACE WILL BE WIDENED. EXISTING TREES WILL BE REMOVED.

IMPORTANT:

- THE CITY IS NOT BUYING THE EASEMENT BACK. THEY GAVE IT TO US LONG AGO.
- THE CHURCH WILL NOT HAVE TO PAY FOR ANYTHING THE CITY DECIDES TO DO. (ALL THE CONSTRUCTION IS AT THE EXPENSE OF THE CITY)
- CHURCH SIGN WILL NOT BE REPLACED. THE SIGN WILL BE WITHIN 1' TO 2' OF SIDEWALK.
- GRACE WILL PICK AN OPTION AT JULY'S VOTERS MEETING.
- NO MATTER WHAT OPTION GRACE PICKS, THE CITY STILL HAS THE ULTIMATE DECISION.
- IF YOU HAVE ANY QUESTIONS PLEASE ASK THEM (SEE TRUSTEE'S JEREMY CAGLE OR MATT PROCTOR)

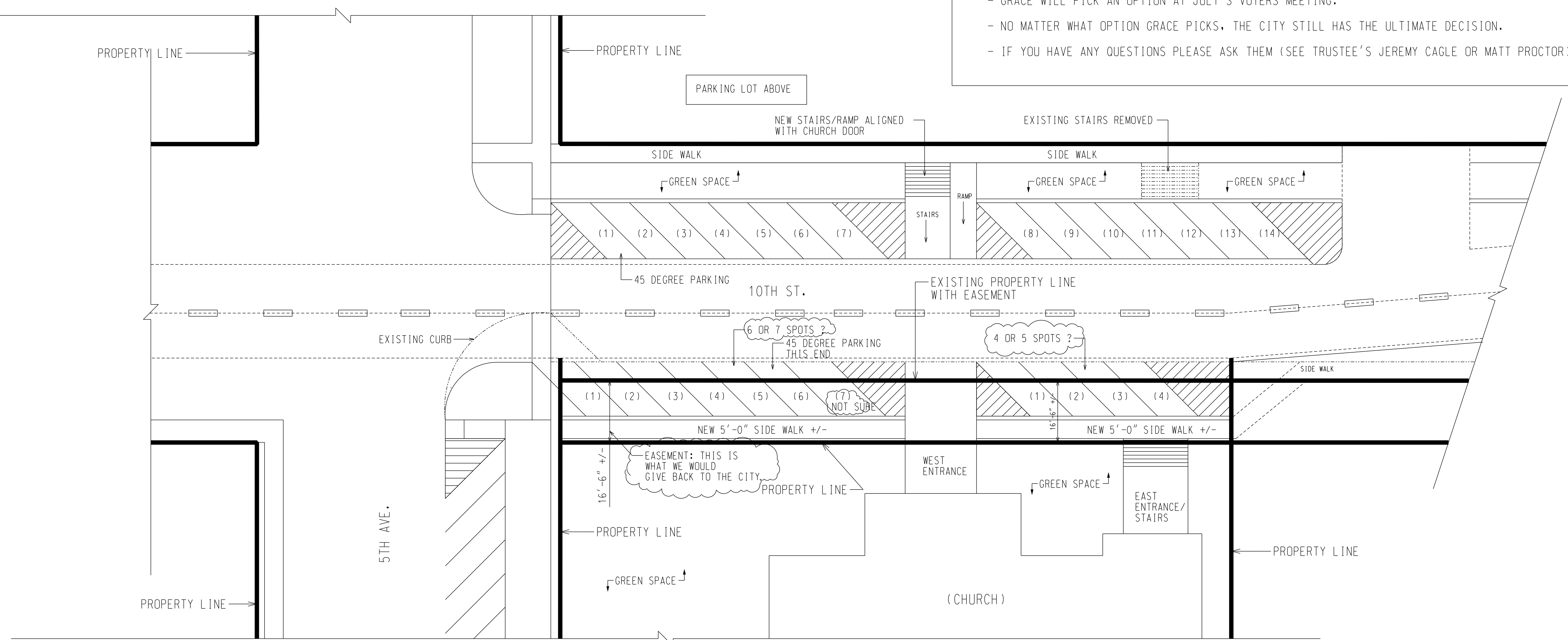

OPTION #3 SHOWN
45 DEGREE PARKING

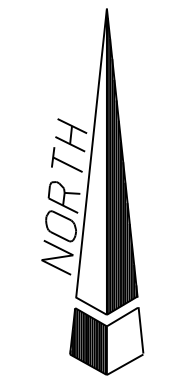

EVERYTHING SHOWN IS NOT EXACT.
THIS DRAWING SHOULD ONLY BE USED TO SHOW WHAT
EACH OPTION MIGHT LOOK LIKE.

(GREEN FLAGS)

(SEE GREEN FLAGS FOR LOCATION OF INSIDE FACE OF CURBS)

NOTE: THE FLAGS ONLY SHOW WHERE THE FRONT TIRE WILL BE.
6'-0" +/- FOR SIDE WALK & CURB MUST BE ADDED BEYOND THE
LOCATION OF FLAGS. THIS WILL BE WHAT THE CHURCH GIVES
BACK TO THE CITY.

CHANGES TO PROPERTY

- CHURCH GIVES BACK 16'-6" +/- OF EASEMENT FOR 45 DEGREE PARKING.
- CHURCH GIVES BACK 8'-9" +/- OF EASEMENT FOR PARALLEL PARKING.
- EAST ENTY STAIR LANDING (AT TOP) WILL BE SHORTENED. STAIRS WILL BE REPLACED AND STILL FACE NORTH.
- RAMP/STAIRS ADDED TO NORTH SIDE PARKING. REMOVE OLD STEPS.
- NORTH PARKING WILL MOVE SOUTH AND GREEN SPACE WILL BE WIDENED. EXISTING TREES WILL BE REMOVED.

IMPORTANT:

- THE CITY IS NOT BUYING THE EASEMENT BACK. THEY GAVE IT TO US LONG AGO.
- THE CHURCH WILL NOT HAVE TO PAY FOR ANYTHING THE CITY DECIDES TO DO. (ALL THE CONSTRUCTION IS AT THE EXPENSE OF THE CITY)
- CHURCH SIGN WILL NOT BE REPLACED. THE SIGN WILL BE WITHIN 1' TO 2' OF SIDEWALK.
- GRACE WILL PICK AN OPTION AT JULY'S VOTERS MEETING.
- NO MATTER WHAT OPTION GRACE PICKS, THE CITY STILL HAS THE ULTIMATE DECISION.
- IF YOU HAVE ANY QUESTIONS PLEASE ASK THEM (SEE TRUSTEE'S JEREMY CAGLE OR MATT PROCTOR)

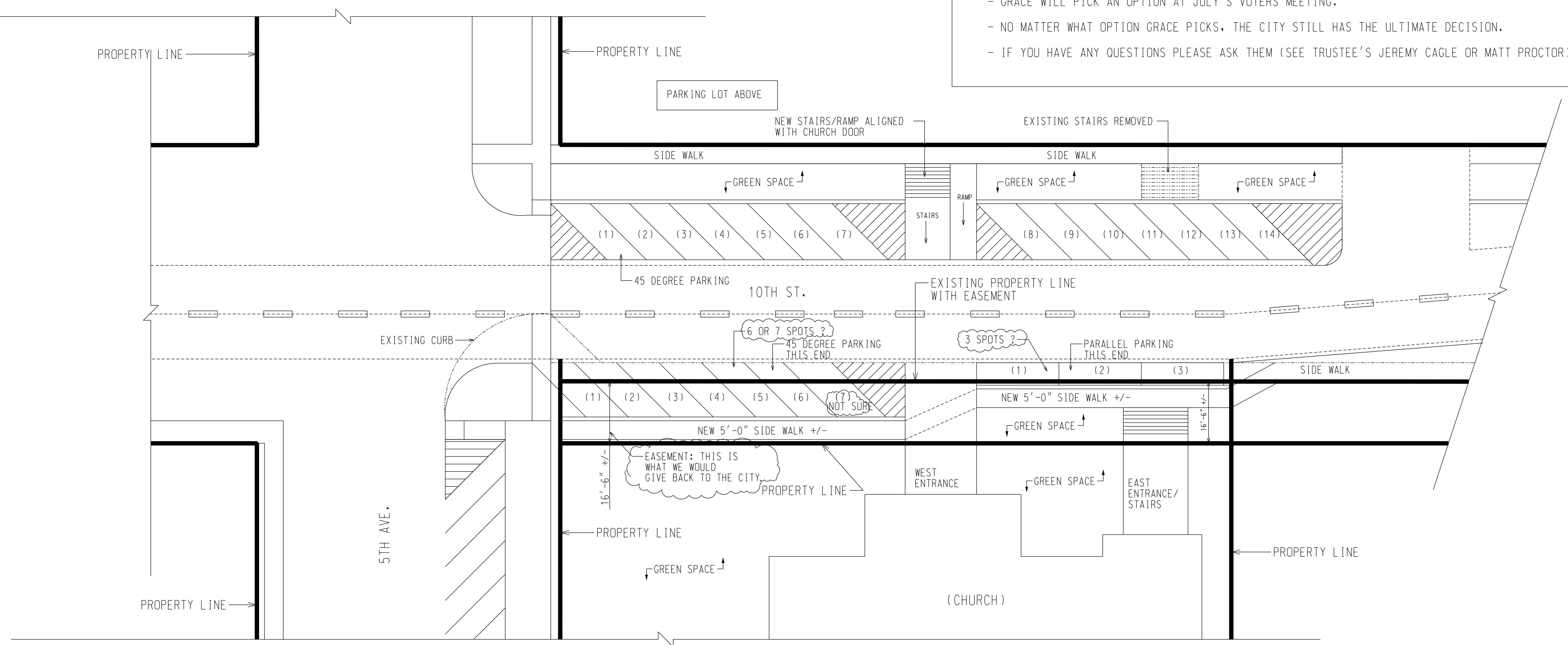

OPTION #2 SHOWN
45 DEGREE PARKING & PARALLEL PARKING

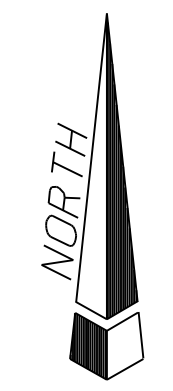

EVERYTHING SHOWN IS NOT EXACT.
THIS DRAWING SHOULD ONLY BE USED TO SHOW WHAT
EACH OPTION MIGHT LOOK LIKE.

(RED FLAGS)

(SEE RED FLAGS FOR LOCATION OF INSIDE FACE OF CURBS)

NOTE: THE FLAGS ONLY SHOW WHERE THE FRONT TIRE WILL BE.
6'-0" +/- FOR SIDE WALK & CURB MUST BE ADDED BEYOND THE
LOCATION OF FLAGS. THIS WILL BE WHAT THE CHURCH GIVES
BACK TO THE CITY.

CHANGES TO PROPERTY

- CHURCH GIVES BACK 8'-9" +/- OF EASEMENT FOR PARALLEL PARKING.
- EAST ENTY STAIR LANDING (AT TOP) WILL BE SHORTENED. STAIRS WILL BE REPLACED AND STILL FACE NORTH.
- RAMP/STAIRS ADDED TO NORTH SIDE PARKING. REMOVE OLD STEPS.
- NORTH PARKING WILL MOVE SOUTH AND GREEN SPACE WILL BE WIDENED. EXISTING TREES WILL BE REMOVED.

IMPORTANT:

- THE CITY IS NOT BUYING THE EASEMENT BACK. THEY GAVE IT TO US LONG AGO.
- THE CHURCH WILL NOT HAVE TO PAY FOR ANYTHING THE CITY DECIDES TO DO. (ALL THE CONSTRUCTION IS AT THE EXPENSE OF THE CITY)
- CHURCH SIGN WILL NOT BE REPLACED. THE SIGN WILL BE WITHIN 1' TO 2' OF SIDEWALK.
- GRACE WILL PICK AN OPTION AT JULY'S VOTERS MEETING.
- NO MATTER WHAT OPTION GRACE PICKS, THE CITY STILL HAS THE ULTIMATE DECISION.
- IF YOU HAVE ANY QUESTIONS PLEASE ASK THEM (SEE TRUSTEE'S JEREMY CAGLE OR MATT PROCTOR)

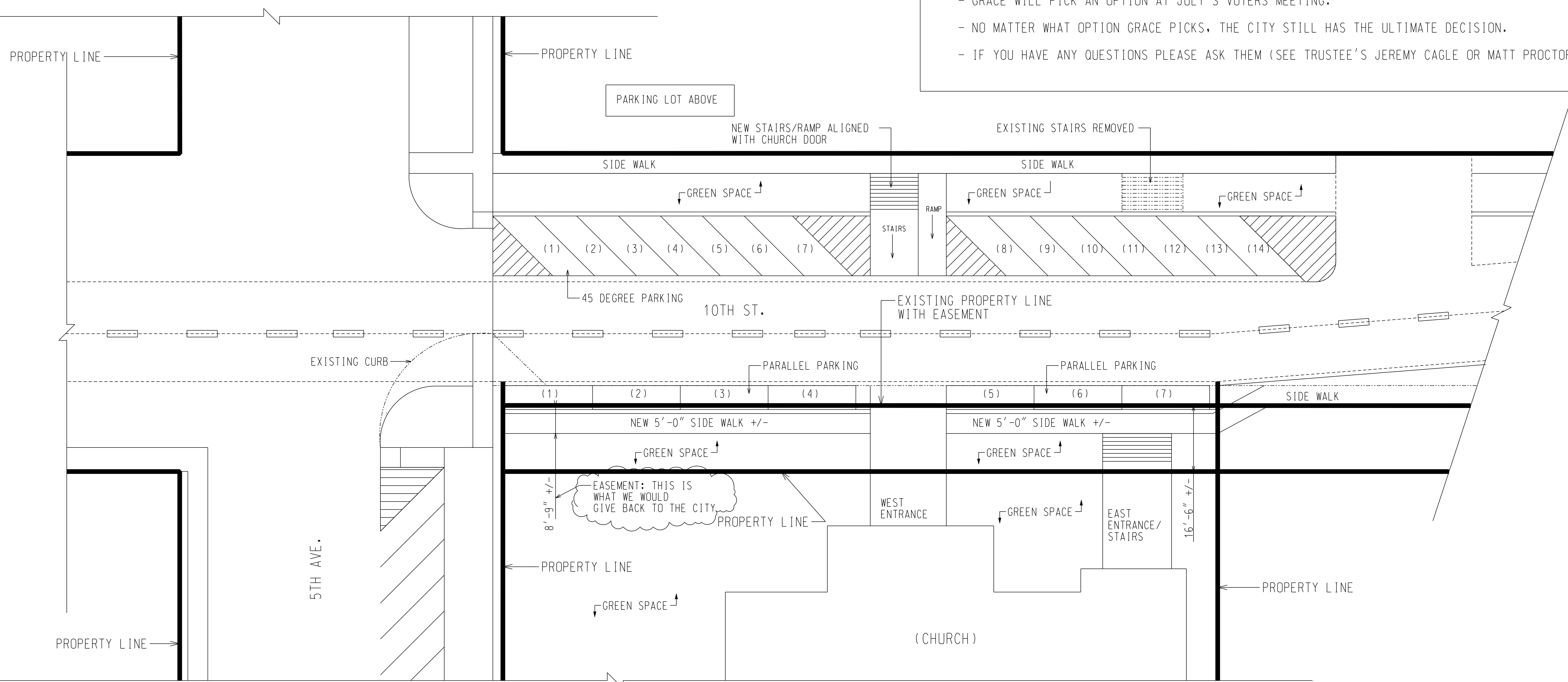

OPTION #1 SHOWN
PARALLEL PARKING

